

Cameras for vicosys®

Guppy

Colour cameras of Guppy series

Product features

- Digital FireWire cameras of most diverse resolutions
- External trigger
- Progressive Scan
- High Framerate
- Flexible AOI
- Extremely small design
- Compact and robust construction
- C-mount (thread connection)
- Very good price achievement relationship



Engineering drawing

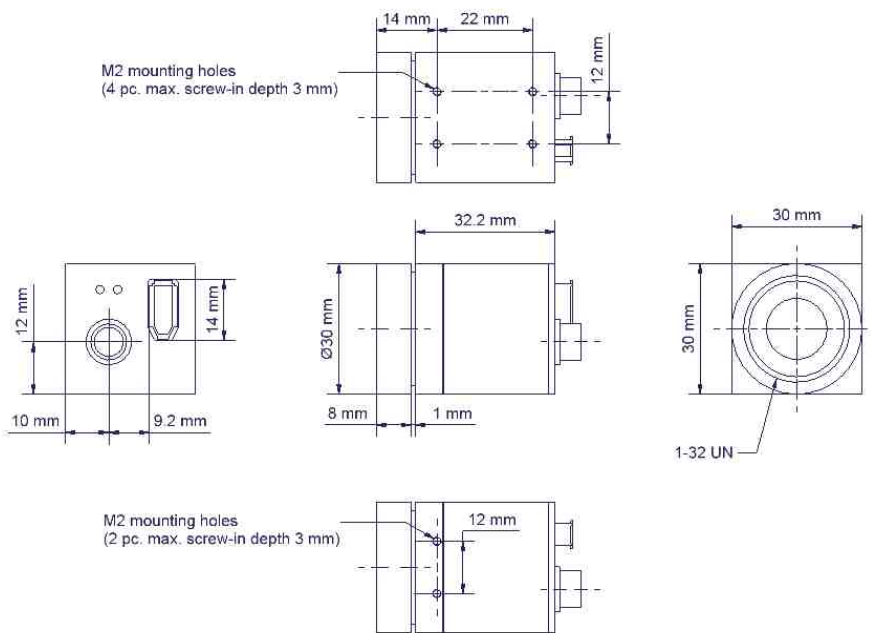

Download
Manual



Download
CAD-File



**NEW
2008**

Definition

The cameras of the Guppy series are available as black/ white and also as color cameras.

The FireWire cameras of the Guppy series differs only in the characteristics of the chip and the maximum framerate.

Variants

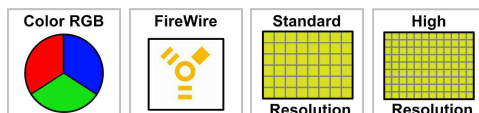

Cameras for vicosys®

Guppy Colour cameras of Guppy series

Technical data

Model	Guppy F-033C 4-22-021	Guppy F-046C 4-22-023	Guppy F-080C 4-22-025	Guppy F-146C 4-22-040
Sensor	1/3" Sony CCD, colour, progressive scan	1/2" Sony CCD, colour, progressive scan	1/3" Sony CCD, colour, progressive scan	1/2" Sony CCD, colour, progressive scan
Pixel number	640 x 480	782 x 582	1024 x 768	1392 x 1040
Cell size	7.4 μm x 7.4 μm	8.3 μm x 8.3 μm	4.65 μm x 4.65 μm	4.65 μm x 4.65 μm
Analogue-digital converter	10 bit	12 bit	12 bit	12 bit
Color modes	Raw8	Raw8	Raw8	Raw8
Lens mount	C-Mount	C-Mount	C-Mount	C-Mount
Data interface	IEEE 1394a	IEEE 1394a	IEEE 1394a	IEEE 1394a
Transfer rate	100, 200, 400 Mbit/s	100, 200, 400 Mbit/s	100, 200, 400 Mbit/s	100, 200, 400 Mbit/s
Full frame frequency	60 Hz	53 Hz	30 Hz	17.7 Hz
Gain Control	Manual: 0 ... 24 dB; Auto gain	Manual: 0 ... 24 dB; Auto gain	Manual: 0 ... 24 dB; Auto gain	Manual: 0 ... 24 dB; Auto gain
Shutter	20 μs ...67s, Auto Shutter	20 μs ...67s, Auto Shutter	20 μs ...67s, Auto Shutter	20 μs ...67s, Auto Shutter
External trigger	Yes	Yes	Yes	Yes
Voltage supply	8 ... 36 VDC (via IEEE 1394 port)	8 ... 36 VDC (via IEEE 1394 port)	8 ... 36 VDC (via IEEE 1394 port)	8 ... 36 VDC (via IEEE 1394 port)
Weight	< 50 g	< 50 g	< 50 g	< 50 g
Dimensions	30 x 30 x 48.2 mm ³	30 x 30 x 48.2 mm ³	30 x 30 x 48.2 mm ³	30 x 30 x 48.2 mm ³
Operating temperature	+5 ... 50 °C	+5 ... 50 °C	+5 ... 50 °C	+5 ... 50 °C

Variants

Variants	Guppy F-033C	Guppy F-046C	Guppy F-080C	Guppy F-146C
Order number	4-22-021	4-22-023	4-22-025	4-22-040

Cameras for vicosys®

Guppy

Colour cameras of Guppy series

Notes

Scope of delivery

Guppy Camera
Camera cable IEEE 1394 4.5 m

Technical diagram

Spectral Response Guppy F-033C

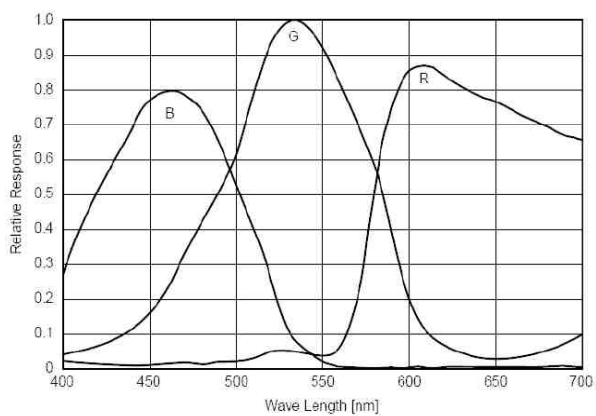

Spectral Response Guppy F-046C

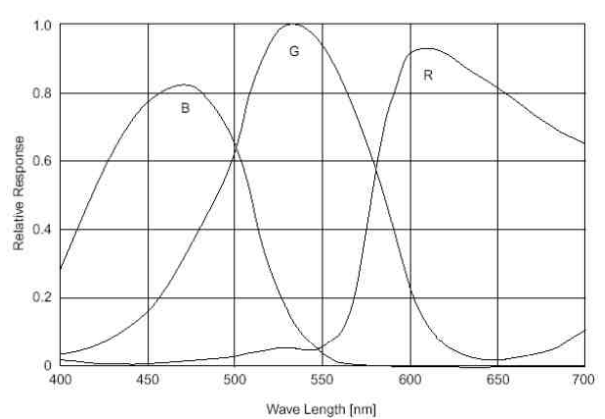

Cameras for vicosys®

Guppy

Colour cameras of Guppy series

Technical diagram

Spectral Response Guppy F-080C

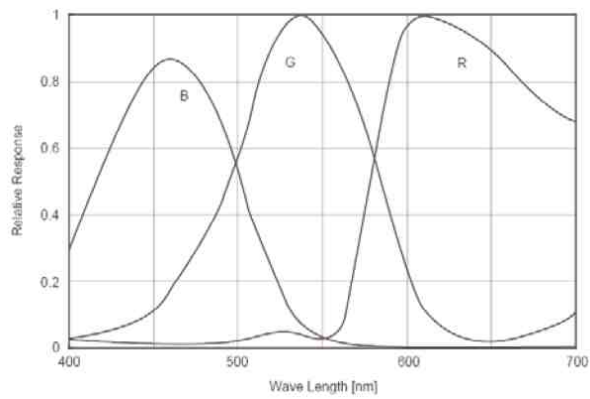

Spectral Response Guppy F-146C

